

# NEW CONSTRUCTION WINDOW INSTALLATION

Rev. 12/31/07

## NOTICE: READ BEFORE INSTALLING

### GENERAL INFORMATION:

IMPROPER INSTALLATION AND CARE MAY VOID WARRANTY. THESE INSTRUCTIONS ARE A BASIC/GENERAL RECOMMENDATION FOR INSTALLATION, BUT MAY NOT BE UTILIZED IN EVERY APPLICATION METHOD. THE MANUFACTURER ASSUMES NO RESPONSIBILITY FOR FAILURE, PERFORMANCE OR INJURY FROM IMPROPER INSTALLATION METHODS, CARE AND OR USE.

### RECOMMENDED INSTALLATION:

1. Remove any shipping blocks and wrappings from the window.

2. Check the dimensions of the rough opening to be certain the window is sized correctly. The R.O. is 1" larger than the jamb size, allowing adequate space for the window to be adjusted plumb and square. It also allows adequate room for shimming and insulation.

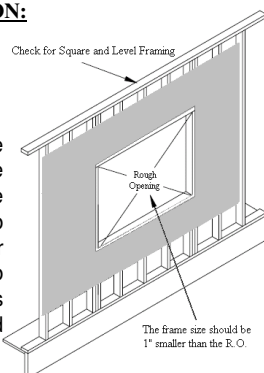

3. Apply a Sill flashing which will extend 6" beyond each side of the window or RO.

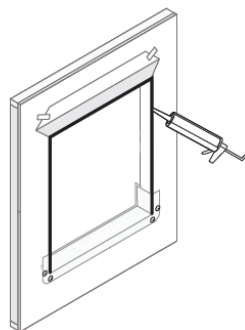

4. Apply a 3/8" continuous bead of caulk at the window head and jambs to the wall or back side of the nailing fin. **DO NOT APPLY CAULK ACROSS THE NAILING FLANGE ON THE BOTTOM SILL.**

5. Carefully, set the window in the opening, a helper should assist in properly shimming the window from the interior, while the installer on the exterior begins to temporarily fasten the window.

\*\* (See Diagram "A" above)

Diagram A:

Shim accordingly. Number of shims will vary with window size.

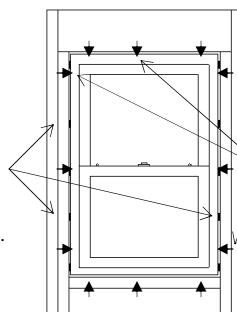

Equal measurements required at points both horizontally and vertically.

Use galvanized roofing nails or corrosion resistant screws that are long enough to penetrate into the framing material by at least 1 1/4".

6. Casement Windows: -----  
On the Hinge side, start by fastening through the nail fin about 4" down from the top corner of the window to temporarily hold the window in place while you place a level along the side jamb and adjust the window until it is plumb. Place another fastener at least 4" up from the bottom on the hinged side. Next, raise and shim the side opposite the hinge until the sightlines between the frame and sash are equal.

Hung and Sliding Windows: -----  
Level the bottom sill of the window and fasten into the nailing fin in one corner. Check the window for square. Measure the frame horizontally and vertically at the top, middle and bottom to verify that all measurements are consistent and shim accordingly and checking for equal sightlines.

\*\*Horizontal Slider windows may require an extra fastener thru the interior sash track of the mainframe, for removal of the sashes. Use of a vinyl 3/8" hole plug may be required.

7. Once square, plumb and level, apply fasteners to the remaining corners (**Do NOT fasten in the nail holes located 4" within each corner**). Repeat the fastening process for the top and bottom nail fins. **Fastening in every other nail hole is recommended.**

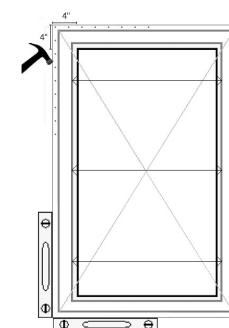

8. Apply flashing to the side and head jambs per diagram below, covering the nail holes...Install the supplied drip cap for nail fin application above windows

Extend the jamb flashing beyond and over the sill flashing and 1" above the top edge of the head nailing fin. The head flashing must overlap and extend beyond the outer edges of the jamb flashings.

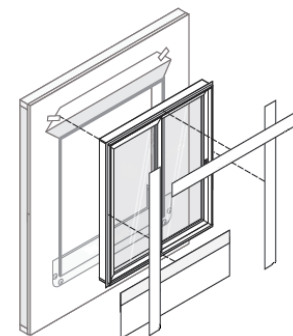

9. Loosely install conventional fiberglass insulation into the cavities between the window frame and the rough opening. Apply a high quality sealant around the window where it meets the siding material.